

ZING Radial Repair Units are developed with the most advanced technology for the reinforcement and repair of Radial tires. They are constructed with special rubber compound with polyester fibers.

ZING Radial Repairs offer high strength and greater flexibility due to single direction ply and locking wedge construction. Thus, they enhance the life of tires and hence, saving thousands of bucks on the new tires.

ZING Radial Repair Units can be used to repair sidewall, crown and shoulder injuries in passenger car, truck, tractor and earthmover tires. ZING Radial Repair Chart (Page No. 2 & 3) can be used to determine the proper repair size of injury.

ZING Radial Repair Units (Product Code 920 onwards) are supported with hard cardboard so that the border of cushion gum do not get wringed in the transportation of the goods.

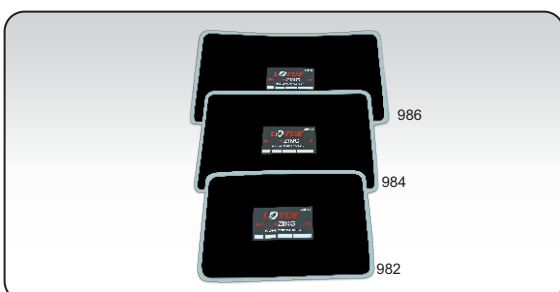
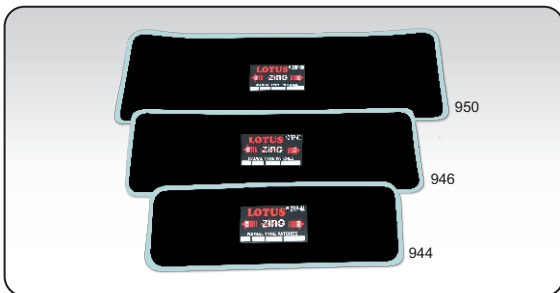

Product Code	Description	Size		Ply Rating	Box Quantity
		(inches)	(mm)		
910	ZRP-10	2 1/8" x 3 1/2"	53 x 87	1	20
910HD	ZRP-10 HD	2 1/2" x 3 1/2"	65 x 87	1	20
912	ZRP-12	2 5/8" x 4 3/4"	67 x 122	1	10
912HD	ZRP-12 HD	2 5/16" x 5 1/8"	74 x 130	1	10
914	ZRP-14	3" x 6"	78 x 152	1	10



Product Code	Description	Size		Ply Rating	Box Quantity
		(inches)	(mm)		
920	ZRP-20	3 1/4" x 5 3/8"	83 x 135	2	10
922	ZRP-22	3 1/4" x 6 7/8"	83 x 175	2	10
924	ZRP-24	3 5/8" x 9"	92 x 230	2	10
926	ZRP-26	3 1/4" x 10"	83 x 255	3	10
933	ZRP-33*	4 1/8" x 5 1/8"	105 x 130	3	10
935	ZRP-35*	5 1/8" x 6 1/8"	130 x 155	4	10
937	ZRP-37*	5" x 7"	127 x 175	4	10
940	ZRP-40	4 1/8" x 8 3/8"	105 x 212	3	10
942	ZRP-42	5" x 10"	127 x 255	4	10
944	ZRP-44	5 1/8" x 13 1/4"	130 x 335	4	10



Product Code	Description	Size		Ply Rating	Box Quantity
		(inches)	(mm)		
945	ZRP-45*	9 1/2" x 7 1/4"	240 x 185	4	10
955	ZRP-55*	13" x 10 1/2"	330 x 265	5	5
965	ZRP-65*	16 1/2" x 13"	420 x 330	6	5
975	ZRP-75*	21" x 18"	535 x 455	8	5



Product Code	Description	Size		Ply Rating	Box Quantity
		(inches)	(mm)		
946	ZRP-46	5 1/2" x 16"	140 x 405	4	5
946HD	ZRP-46HD	6 1/8" x 16 1/2"	155 x 420	4	5
950	ZRP-50	8 1/4" x 20"	208 x 510	5	5
952	ZRP-52	10" x 19 7/8"	255 x 505	5	5
952HD	ZRP-52HD	10" x 22 3/4"	255 x 575	5	5
956	ZRP-56	10 1/2" x 26"	265 x 660	6	5
956HD	ZRP-56HD	10 1/2" x 29 1/2"	265 x 750	7	5



Product Code	Description	Size		Ply Rating	Box Quantity
		(inches)	(mm)		
980	ZRP-80	6 1/8" x 7 7/8"	155 x 200	2	5
982	ZRP-82	7 3/4" x 10 1/4"	195 x 260	3	5
984	ZRP-84	8 5/8" x 11 3/4"	220 x 300	3	5
986	ZRP-86	10" x 13 3/4"	255 x 350	3	5

*For Crown Injuries only

- A-B** – Non-Repairable Area
- C** – Maximum Diameter of Damaged Radial Cables
- W** – Width of Injury
- L** – Length of Injury
- S-T** – Shoulder Area
1½" or 40 mm
- T-T** – Crown Area

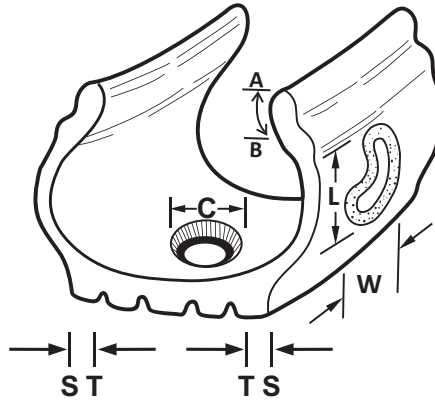

A-B - Non-Repairable Area

Passenger and light truck tires 1½", 40 mm

Section Width

6.50-7.00 (165-195) 2½", 65mm
 7.50-16.00 (190-385) 3", 75mm
 17.5-23.5 (425-600) 3½", 90mm

Non-repairable area is measured from the bead toe down the inside of the inner liner of the tire.



Sidewall Injury		Passenger Tire Sizes		Crown Injury Diameter
Width	Length	125-75	185-255	
¼" (6mm)	½" (13mm)	10	10	¼" (6mm)
¼" (6mm)	2" (50mm)	12	12	
⅜" (10mm)	⅜" (10mm)	10	10	⅜" (10mm)
⅜" (10mm)	1½" (40mm)	12	12	
⅜" (10mm)	2" (50mm)	14	14	
½" (13mm)	1½" (40mm)	12	12	½" (13mm)
½" (13mm)	2" (50mm)	14	14	
¾" (20mm)	¾" (20mm)	12	12	¾" (20mm)
¾" (20mm)	1½" (40mm)	12	14	
¾" (20mm)	2" (50mm)	14	14	
1" (25mm)	1½" (40mm)	14	14	
1" (25mm)	2" (50mm)	14	22	1" (25mm)

Repair Units in Red are to be used for Crown or Sidewall Injuries. To maintain their Speed Rating, Passenger Tires carrying a Speed Rating of H,V or Z should only be repaired in the Crown (T-T) Area with a maximum limitation of ¼" (6 mm).



Sidewall Injury		Tractor Tire Sizes		Crown Injury Diameter
Width	Length	8-11 8.3-12.4	12-15 13.6-30.5 440/65-800/65	
¼" (6mm)	¼" (6mm)	12	12	⅜" (10mm)
⅜" (10mm)	⅜" (10mm)	12	12	
⅜" (10mm)	1½" (40mm)	20	20	
⅜" (10mm)	5" (125mm)	26	26	¾" (20mm)
¾" (20mm)	¾" (20mm)	20	20	
¾" (20mm)	3" (75mm)	22	80	1½" (40mm)
½" (40mm)	4" (100mm)	80	82	
2" (50mm)	3¼" (80mm)	80	82	2¾" (70mm)
2½" (65mm)	3" (70mm)	80	82	
2½" (65mm)	4" (100mm)	82	82	
2¾" (70mm)	2¾" (70mm)	80	82	3½" (90mm)
3¼" (80mm)	3¼" (80mm)	82	82	
3¼" (80mm)	5¼" (130mm)	84	84	
3½" (90mm)	4½" (115mm)	84	84	
4" (100mm)	4" (100mm)	84	84	5¼" (130mm)
4" (100mm)	6½" (165mm)	86	86	
5¼" (130mm)	5¼" (130mm)	86	86	

Repair Units in Red are to be used for Crown or Sidewall Injuries. The Section Repair Chart is a guideline only. Load, Speed and Highway Application can affect the limitation of section repairs.



Sidewall Injury		Truck Tire Sizes			Crown Injury Diameters (T-T Area)
Width	Length	6.50-12.50	7.50-10.00	11.00-14.00	
¼" (6mm)	¼" (6mm)	10	10HD, 20	10HD, 20	¼" (6mm)
¼" (6mm)	¼" (6mm)	12	12HD, 20	12HD, 20	
1 Cable	1½" (40mm)	20	20	20	¾" (10mm)
1 Cable	3⅝" (80mm)	22	22	22	
1 Cable	4¾" (120mm)	24	24	24	
1 Cable	6" (150mm)	26	26	26	
2 Cable	¾" (20mm)	20	20	22	¾" (10mm)
2 Cable	1½" (40mm)	20	22	24	
2 Cable	2⅜" (60mm)	22	24	26	
2 Cable	5⅝" (130mm)	26	26	26	
⅜" (10mm)	1½" (40mm)	20	26	40	½" (13mm)
⅜" (10mm)	2⅜" (60mm)	22	26	40	
⅜" (10mm)	3⅝" (80mm)	26	26	42	
⅜" (10mm)	5⅝" (130mm)	26	26	44	
½" (13mm)	1½" (40mm)	22	33	33	¾" (20mm)
½" (13mm)	2¾" (70mm)	22	40	40	
½" (13mm)	3¾" (95mm)	40	42	42	
½" (13mm)	5⅝" (130mm)	44	44	44	
¾" (20mm)	1" (25mm)	22	33	35	1" (25mm)
¾" (20mm)	2½" (65mm)	24	42	42	
¾" (20mm)	4⅝" (110mm)	42	42	44	
¾" (20mm)	5⅝" (130mm)	44	44	44	
1" (25mm)	2" (50mm)	33	35	35	1¼" (32mm)
1" (25mm)	3¼" (80mm)	40	42	44	
1" (25mm)	4" (100mm)	44	44	44	
1¼" (32mm)	2" (50mm)		37	37	1¼" (40mm)
1¼" (32mm)	3⅝" (80mm)		42	44	
1¼" (32mm)	4" (100mm)		44	46	
1¼" (40mm)	2" (50mm)		37, 44	37	1¼" (40mm)
1¼" (40mm)	3⅝" (75mm)			44	

Yellow Tube Type Tire Sizes Purple Tubeless Tire Sizes

Repair Units **Boxed In Red** are limited to Crown (T-T) Area only. All others shown in Red may be used for Crown or Sidewall Injuries. Note: This Section Repair Chart is a guideline only. Load, Speed and Highway Application can affect the limitation of section repairs.



Sidewall Injury		Shoulder Injury Inches (mm)	Earthmover Tire Size				Crown Injury Inches (mm)
Width Inches (mm)	Length Inches (mm)		14.00-16.00 15.5-20.5 20/65-30/65	18.00-21.00 23.5-26.5 35/65	24.00-30.00 29.5-37.5 40/65-45/65	33.00-40.00 48/95-59/80 50/65-65/65	
3/8" (10mm)	3" (75mm)	-	42	42	42	44	3/8" (10mm)
3/8" (10mm)	4 3/8" (110mm)	-	42	42	44	44	
3/4" (20mm)	2" (50mm)		42	44	44	50	3/4" (20mm)
3/4" (20mm)	5 1/2" (140mm)		46	46	46	50	
3/4" (20mm)	8" (200mm)	3/4" (20mm)	46	50	50	50	
			46	46	50	52	
1" (25mm)	5" (125mm)		45	45	45	45	1" (25mm)
1" (25mm)	8" (200mm)		46	46	46	50	
		1" (25mm)	50	50	50	52	
			46	50	52	52	
1 1/4" (30mm)	4" (100mm)		46	50	50	50	1 1/2" (40mm)
1 1/4" (30mm)	10" (250mm)		50	50	52	56	
			46	50	52	56	
1 1/2" (40mm)	3 1/2" (90mm)		45	45	55	55	1 1/2" (40mm)
1 1/2" (40mm)	10" (250mm)		46	52	52	52	
1 1/2" (40mm)	14" (350mm)		50	50	52	56	
1 1/2" (40mm)	16" (400mm)		56	56	56	60	
		1 1/2" (40mm)	60	60	60	60	
			50	50	52	56	
1 3/4" (45mm)	6 1/2" (165mm)		50	50	50	52	2" (50mm)
1 3/4" (45mm)	10" (250mm)		52	52	52	56	
1 3/4" (45mm)	14" (350mm)		56	56	56	60	
1 3/4" (45mm)	16" (400mm)		60	60	60	60	
			50	52	56	56	
		2" (50mm)	50	52	56	56	
2" (50mm)	7" (175mm)		55	55	55	65	2" (50mm)
2" (50mm)	10" (250mm)		50	50	50	52	
2" (50mm)	14" (350mm)		52	52	52	56	
2" (50mm)	16" (400mm)		56	56	56	60	
2" (50mm)	16" (400mm)		60	60	60	60	
2" (50mm)	19" (475mm)		60	60	60	60	
2 3/4" (70mm)	8" (200mm)		55	65	65	65	2 3/4" (70mm)
2 3/4" (70mm)	10" (250mm)		52	52	52	56	
2 3/4" (70mm)	13 1/2" (340mm)	2 1/2" (65mm)	56	56	72	72	
		2 3/4" (70mm)	72	72	72	72	
3 1/2" (90mm)	7" (175mm)		52	75	75	75	3 1/2" (90mm)
3 1/2" (90mm)	8" (200mm)		52	52	56	56	
3 1/2" (90mm)	10" (250mm)		52	52	56	72	
3 1/2" (90mm)	12 1/2" (315mm)	3 1/2" (90mm)	56	56	60	60	
4" (100mm)	5 1/2" (140mm)		52	52	52	56	5" (125mm)
4" (100mm)	7 1/2" (190mm)		52	56	56	72	
4" (100mm)	10 1/2" (265mm)		56	60	60	60	
4 3/8" (110mm)	5" (125mm)		52	52	56	56	
4 3/8" (110mm)	7" (175mm)		52	56	72	72	
4 3/8" (110mm)	10" (250mm)		60	60	60	60	
4 3/4" (120mm)	4 1/2" (115mm)		52	52	56	56	5" (125mm)
4 3/4" (120mm)	6" (150mm)		52	56	60	60	
4 3/4" (120mm)	9" (225mm)		60	60	60	60	
5" (125mm)	4" (100mm)			75	75	75	6 1/2" (165mm)
5" (125mm)	5" (125mm)			72	72	72	
5" (125mm)	7" (175mm)			72	72	72	
6" (150mm)	3" (75mm)			72	72	72	6 1/2" (165mm)
6" (150mm)	5 1/2" (140mm)			72	72	72	
6 1/2" (165mm)	5" (125mm)			85	85	85	

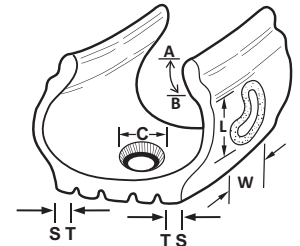

- A-B – Non-Repairable Area
- C – Maximum Diameter of Damaged Radial Cables
- W – Width of Injury
- L – Length of Injury
- S-T – Shoulder Area
1 1/2" or 40 mm
- T-T – Crown Area

DETERMINING CROWN INJURY REPAIR AREA (T-T AREA)

Zing Radial/OTR

Non-Repairable Area

14.00-16.00 (15.5-17.5)	3", 75mm
18.00-24.00 (20.5-29.5)	5", 125mm
27.00-33.00 (33.25-37.5)	6", 150mm
40/60-50/65 (40.5)	6 3/4", 170mm
36.00	8", 200mm
37.00-40.00	10", 255mm
(50.5 & Larger)	

Radial/OTR Crown Dimensions (T-T Area)

Crown is defined as 50% of tread face for standard aspect ratio tire sizes and 60% of tread face for wide base sizes. All measurements are taken on the outside surface of the tire.

Standard Aspect Tire Size Example: (24.00 R35)

If the tread face measures 24" (610mm) wide, 50% of that is 12" (300mm) - the crown area measurement, or 6" (150mm) on each side of the tread centerline. This is where the injury must be located to be considered as a crown area repair.

Wide Base Tire Size Example: (29.5 R29) If the tread face measures 25" (635mm) wide, 60% of that is 15" (375mm) - the crown area measurement, or 7.5" (190mm) on each side of the tread centerline. This is where the injury must be located to be considered as a crown area repair.

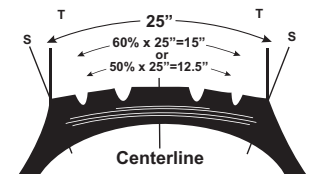

Repair units shown **Boxed in Red** are limited to Crown (T-T) area only.

All others shown in **Red** may be used for Crown or Sidewall injuries.

Note: This Section Repair Chart is a guideline only. Load, Speed and Highway Application can affect the limitations of section repairs.